



# AQUA COUNTRY

**Super luxury project 200 meters from the sea in Behceli area of Girne city.**



[www.EasyToCyprus.com](http://www.EasyToCyprus.com)



# Plan







# Bahchli

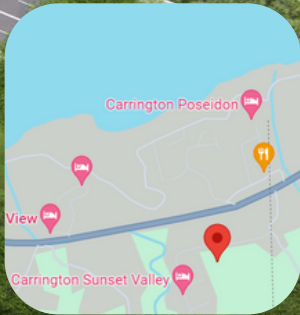



 [www.EasyToCyprus.com](http://www.EasyToCyprus.com)













 [www.EasyToCyprus.com](http://www.EasyToCyprus.com)



# SPECIFICATIONS

-  **Type of document:** Exchange
-  **Land area:** 1000 m<sup>2</sup>
-  **Number of blocks:** 2 villa apartment blocks
-  **Number of units in each block:** 24
-  **Type of units:** 1+1 large terrace, 1+1 duplex
-  **Delivery date:** 2025



[www.EasyToCyprus.com](http://www.EasyToCyprus.com)



- ✓ Walking and cycling path
- ✓ Dedicated parking space
- ✓ Panoramic outdoor pool
- ✓ 24-hour security
- ✓ Children's park
- ✓ BBQ area
- ✓ CCTV
- ✓ Gym



[www.EasyToCyprus.com](http://www.EasyToCyprus.com)



# The size of the project units

**The size of the 1+1 large terrace unit:**

**44 m<sup>2</sup>**

**Size of 1+1 duplex unit:**

**75 m<sup>2</sup>**



[www.EasyToCyprus.com](http://www.EasyToCyprus.com)



# Floor Plan

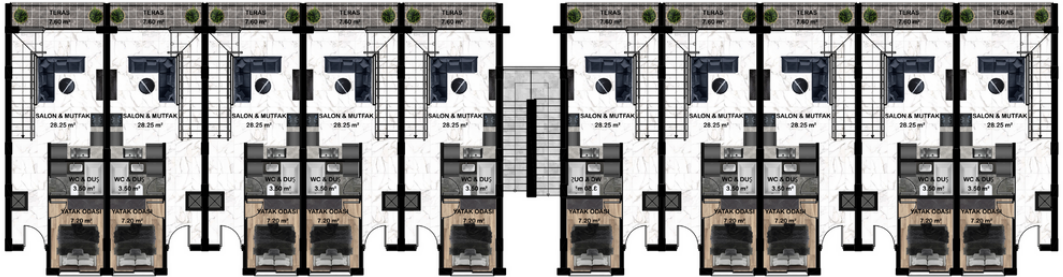

# **Pictures Of Units**









[www.EasyToCyprus.com](http://www.EasyToCyprus.com)









# PAYMENT PLAN

**35%**

**Down Payment**

**65%**

**Interest-free  
installments until the  
unit key is delivered.**

**Delivery Date**

**2025**

[Click to see the  
price list.](#)



[www.EasyToCyprus.com](http://www.EasyToCyprus.com)



## FOLLOW US ON SOCIAL MEDIA



[Easy ToCyprus](#)



[EasyToCyprus](#)



[EasyToCyprus.com](#)

**EMIRAL INVESTMENT**

